



PRAVDHAN

SENSORS & CONTROLS PRIVATE LIMITED



Compliant Product



Certified Product

Open Loop Current Sensor

Model: HOCS - 20... 600 - 12/15/24 (DC Current)

Product:



Applications:

- Power Supplies of Welding Machines
- Robotics
- UPS & SMPS
- Electric Vehicles
- AC Variable Speed Drives
- Batteries related applications
- Automation

Electrical Characteristics:

Supply Voltage	+12 to 24 VDC, $\pm 5\%$
Current Consumption	20mA
Output Voltage @ I_{max} , $R=10K\Omega$ @ $25^\circ C$	0-5 / 0-10 VDC
Accuracy @ $T_a = 25^\circ C$	$\pm 0.5\%$
Linearity	$< \pm 0.5\%$ of I_{max}
(Excluding Electrical Offset) Output Offset Voltage @ 0A	$< \pm 50mV$
Frequency Bandwidth (-3dB)	DC - 150KHz
Insulation resistance @500 VDC	$> 1000 M\Omega$
Load Resistance	$> 6 K\Omega$

Survey no. 344/3, Valia Falia, Near Vasant Falia, Abrama Valsad - 396001, Gujarat, India.

Call @ +91 71604 87551, +91 94268 12657.

E-mail: admin@potsndials.com, pravdhan2022@gmail.com, URL Link: www.potsndials.com



PRAVDHAN

SENSORS & CONTROLS PRIVATE LIMITED



Compliant Product



Certified Product

Electrical Characteristics:

Electrical Offset Voltage, @ 25 °C	< ±50 mV
Hysteresis Offset Voltage@ Ip = 0,after RMS current limit	< ±20 mV
Temperature coefficient of VOE , HOCS-50-24	< ±2 mV/K
Temperature coefficient of VOE , HOCS-100...600-24	< ±1 mV/K
Temperature Coefficient of VOUT (% of reading)	< ±0.1 %/K
Step response time to 90% of RMS current limit	< 5 µSec

Insulation Characteristics:

RMS Voltage for AC Insulation test, 50 Hz/ 1 min	3.6 kV
Impuse withstand voltage 1.2/50 µsec	>6.6 kV

	EN 50178	IEC 61010-1
	Basic Insulation Voltage	Nominal Voltage
Basic Insulation	600 V	600 V
Reinforced Insulation	300 V	300 V

Mechanical Characteristics:

Ambient Operating Temperature	-10°C to +80°C
Ambient Storage Temperature	-25°C to +80°C
Mass	60gm

Survey no. 344/3, Valia Falia, Near Vasant Falia, Abrama Valsad - 396001, Gujarat, India.

Call @ +91 71604 87551, +91 94268 12657.

E-mail: admin@potsndials.com, pravdhan2022@gmail.com, URL Link: www.potsndials.com



Dimensional Drawings:

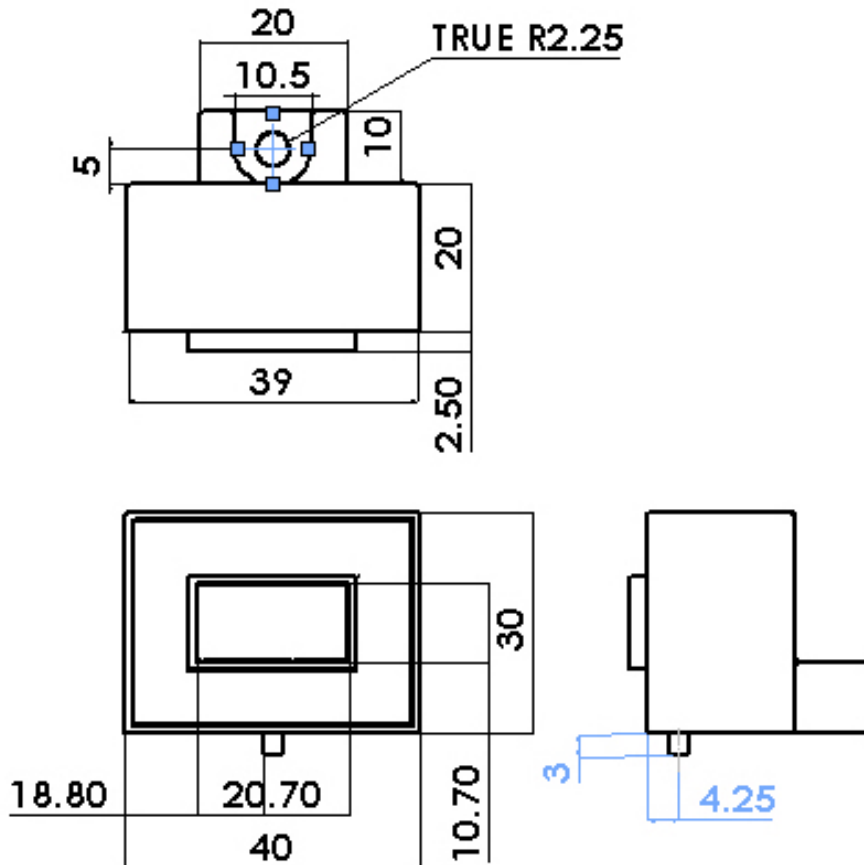

Pin Configurations:

