



PRAVDHAN

SENSORS & CONTROLS PRIVATE LIMITED



Compliant Product



Certified Product

Open Loop Current Sensor

Model: HOCS - 30... 600 - 5

Product:



Applications:

Power Supplies of Welding Machines
 Robotics
 UPS & SMPS
 Electric Vehicles
 AC Variable Speed Drives
 Batteries
 Automation

Electrical Characteristics:

| | |
|---|--------------------------------------|
| Supply Voltage | +5VDC, $\pm 10\%$ |
| Current Consumption | 15 mA |
| Output Voltage @ I_{max} , $R=10K\Omega$ @ $25^\circ C$ | $2.5(50\%) \pm 2(40\%)* (I/I_{max})$ |
| Accuracy @ $T_a = 25^\circ C$ | $\pm 0.5\%$ |
| Linearity | $< 0.5\%$ of I_{max} |
| (Excluding Electrical Offset) Output Offset Voltage @ 0A | $< \pm 25mV$ |
| Frequency Bandwidth (-3dB) | DC -150 KHz |
| Primary Nominal | Any Current Rating |
| RMS Current | From 30 to 600A |

Mechanical Characteristics:

| | |
|-------------------------------|--------------------------------|
| Ambient Operating Temperature | $-40^\circ C$ to $+85^\circ C$ |
| Ambient Storage Temperature | $-40^\circ C$ to $+85^\circ C$ |
| Mass | 60gm |

Survey No. 344/3, Valia Falia, Near Vasant Falia, Abrama, Valsad - 396002, Gujarat, India.

Call @ +91 70164 87551, +91 94268 12657.

E-mail: admin@potsndials.com, pravdhan2022@gmail.com; URL Link: www.potsndials.com



Open Loop Current Sensor

Model: HOCS - 50... 600 - 5

Dimensional Drawings:

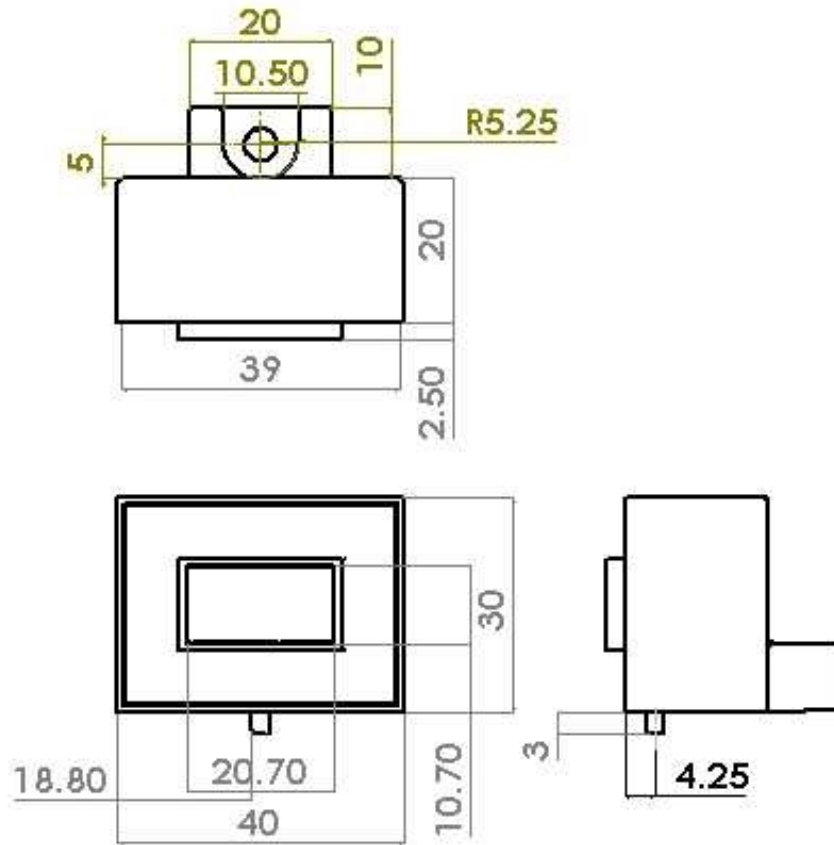

Pin Configurations:

