

Open Loop Current Sensor

Model: SMHS-25..100-5

Product:

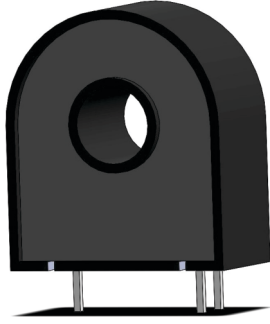

Applications:

- ⇒ Robotics
- ⇒ UPS & SMPS
- ⇒ Electric Vehicles
- ⇒ AC Variable Speed Drives
- ⇒ Batteries
- ⇒ Automation

Electrical Characteristics:

Parameters	Model SMHS-2629
Supply Voltage	+5VDC, ±10%
Current Consumption	10 mA
Output Voltage @ I _{max} , R=10KΩ @ 25°C*	2.5 ± 2 VDC Or 0.5 to 4.5 VDC (Ratiometric V _{DC})
Accuracy @ T _a = 25°C	±1%
Linearity	<1% of I _{max}
Output Offset Voltage @ 0A	< ±20mV
Frequency Bandwidth (-3dB)	DC -5 KHz
Step Response Time	<180 uSec
RMS Current	30, 50, 75, 100A

*Different types of outputs possible as per customer requirement

Mechanical Characteristics:

Ambient Operating Temperature	-40°C to +85°C
Ambient Storage Temperature	-40°C to +85°C
Mass	20gm



Open Loop Current Sensor

Model: SMHS-25..100-5

Dimensional Drawings:

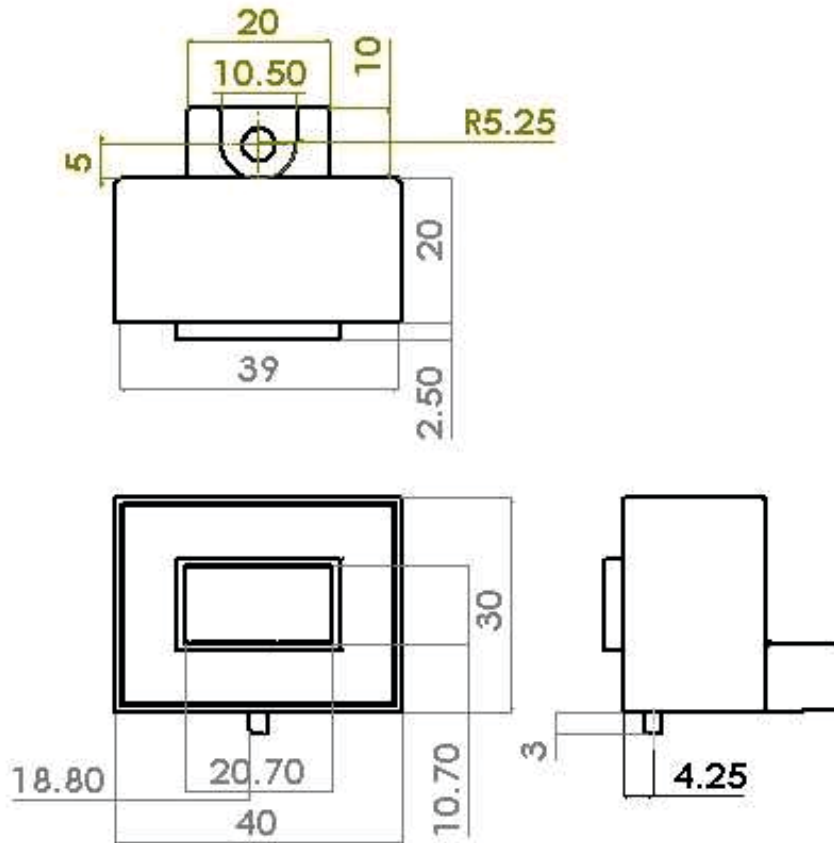

Pin Configurations:

